

# APPENDIX B

**OFFICIAL HACKNEY CARRIAGE STANDS REGULATED BY  
HALTON BOROUGH COUNCIL UNDER SECTION 63 OF  
THE LOCAL GOVERNMENT (MISCELLANEOUS PROVISIONS) ACT 1976**

**WIDNES**

Stand Number	Location	Order Plan Number	Permitted Maximum Number of Vehicles	Permitted Times of Use
1	Market Street	HCS 1	7	2100 - 0600
2	Alforde Street	HCS 2	6	2100 - 0600
3	Hale Road	HCS 3	8	Any
4	Upton Lane	HCS 4	3	Any
5	Dickson Street	HCS 5	5	Any
6	Victoria Square	HCS 6	8	2100 - 0600
7	Prescot Road	HCS 7	4	Any
8	Appleton Village	HCS 8	10	0000 - 0800 & 0930 - 1430 & 1630 - 0000
9	Cronton Lane	HCS 9	4	Any
10	Widnes Road	HCS 10	8	2300 - 0600
11	Albert Road (outside Wetherspoons)	HCS 11	3	1800 - 0600
12	Albert Road (feeder rank to Wetherspoons)	HCS 12	3	1800 - 0600
13	Albert Road (outside Imperial)	HCS 13	3	1800 - 0600

**RUNCORN**

Stand Number	Location	Order Plan Number	Permitted Maximum Number of Vehicles	Permitted Times of Use
14	Public Hall Street	HCS 14	8	Any
15	Shopping City (off Second Avenue)	HCS 15	3	Any
16	High Street (opposite side of road from Chambers)	HCS 16	5	2200 - 0600
17	High Street (in front of Chambers)	HCS 17	5	2200 - 0600
18	Bridge Street (in front of The Wilsons)	HCS 18	4	2200 - 0600
19	High Street (outside Bargain Booze adj Mersey Road)	HCS 19	8	2000 - 0600
20	High Street lay-by immediately east of entrance to Co-op car-park	HCS 20	6	2000 - 0600

# Appendix B

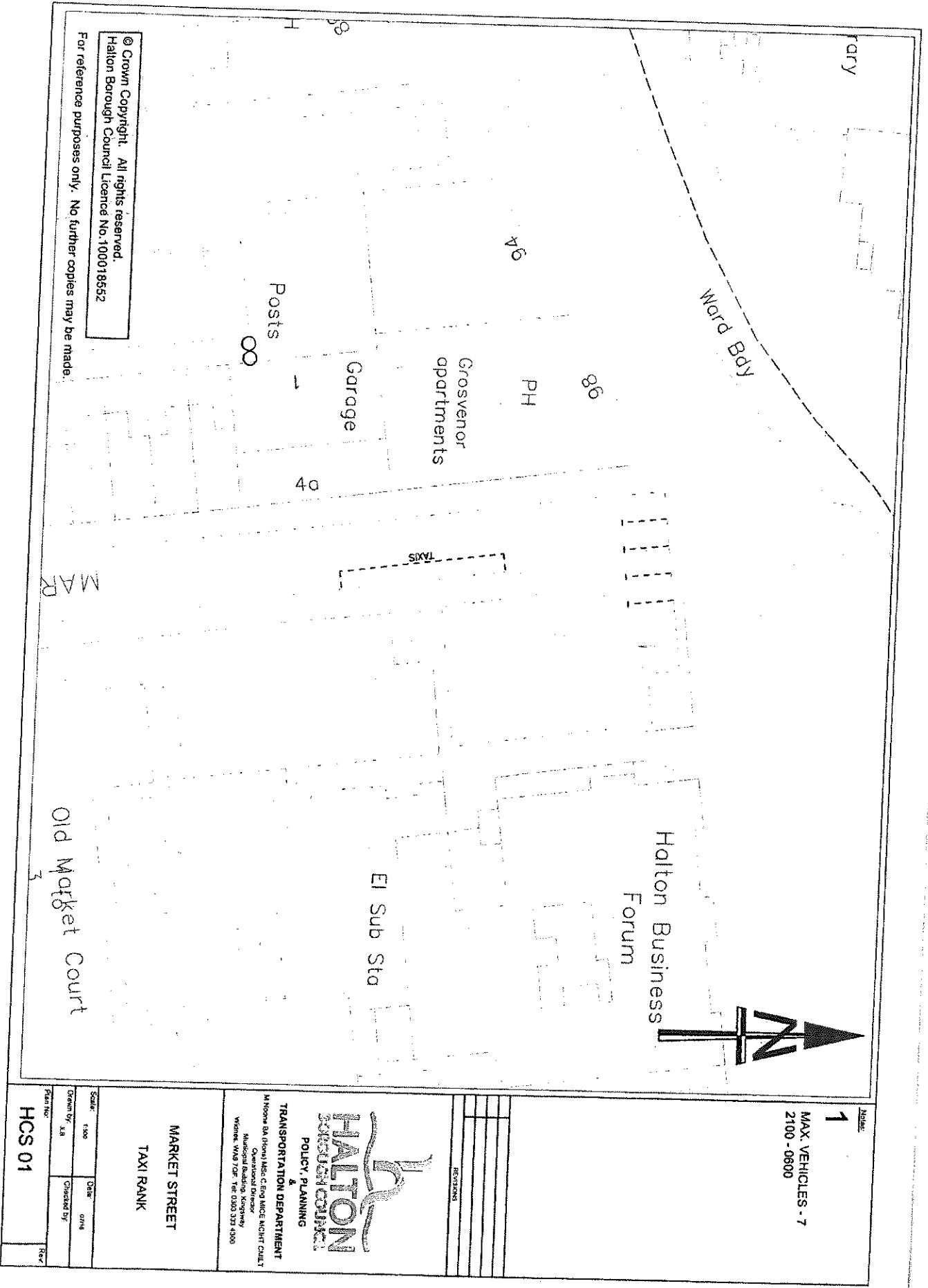

© Crown Copyright. All rights reserved.  
 Halton Borough Council Licence No.100018652

For reference purposes only. No further copies may be made.

Scale: 1:1000  
 Date: 07/14  
 Drawn by: JLR  
 Checked by:

1  
 MAX VEHICLES - 7  
 2100 - 0600



**HALTON BOROUGH COUNCIL**  
 POLICY PLANNING &  
 TRANSPORTATION DEPARTMENT  
 M House BA (Bentley) St, C Bus (Bentley) St, E (Bentley) St  
 Council Building, York  
 Wetherby, WAFS 70F. Tel: 01937 5231300

MARKET STREET  
 TAXI RANK

Plan No: HCS 01

Rev:

Notes:

2

MAX. VEHICLES - 6  
2100 - 0600

REVISIONS



POLICY, PLANNING &

TRANSPORTATION DEPARTMENT

M. Nourse BA (Hons) MSc C.Eng MICE MCIMT CMILT

Operational Director

Municipal Building, Kingsway

Wrexham, Wals Twp. Tel: 0303 333 4300

ALFORDE STREET

TAXI RANK

Scale: 1:500	Date: 07/16
Drawn By: JLB	Checked by:
Plan No:	HCS 02

Rev:



ROSDALE ROAD

Victoria Square

MAJOR CROSS STREET

ALFORDE STREET

The Corner House

Halton Business Forum

El Sub Sta

© Crown Copyright. All rights reserved.  
Halton Borough Council Licence No. 100018552

For reference purposes only. No further copies may be made.

8.8m

1.1m

2

9

8 to 1

11 of 6

3A 36

33 35

3 to 15

26

24

TAXIS

TAXIS

TAXIS

Notes:

3

MAX. VEHICLES - 8  
ANY TIME

REVISIONS



POLICY, PLANNING &  
TRANSPORTATION DEPARTMENT  
M Noone BA (Hons) MSc, C.Eng, MICE, MCIHT, CHRT  
Operational Director  
Municipal Building, Kingsway  
Widnes, Warr. TF9 7DF, Tel: 0929 333 4300

HALE ROAD  
(BLUNDELL ARMS)  
TAXI RANK

Scale: 1:600	Date: 07/19
Drawn by: J.A.	Checked by:
Plan No:	Rev:

HCS 03

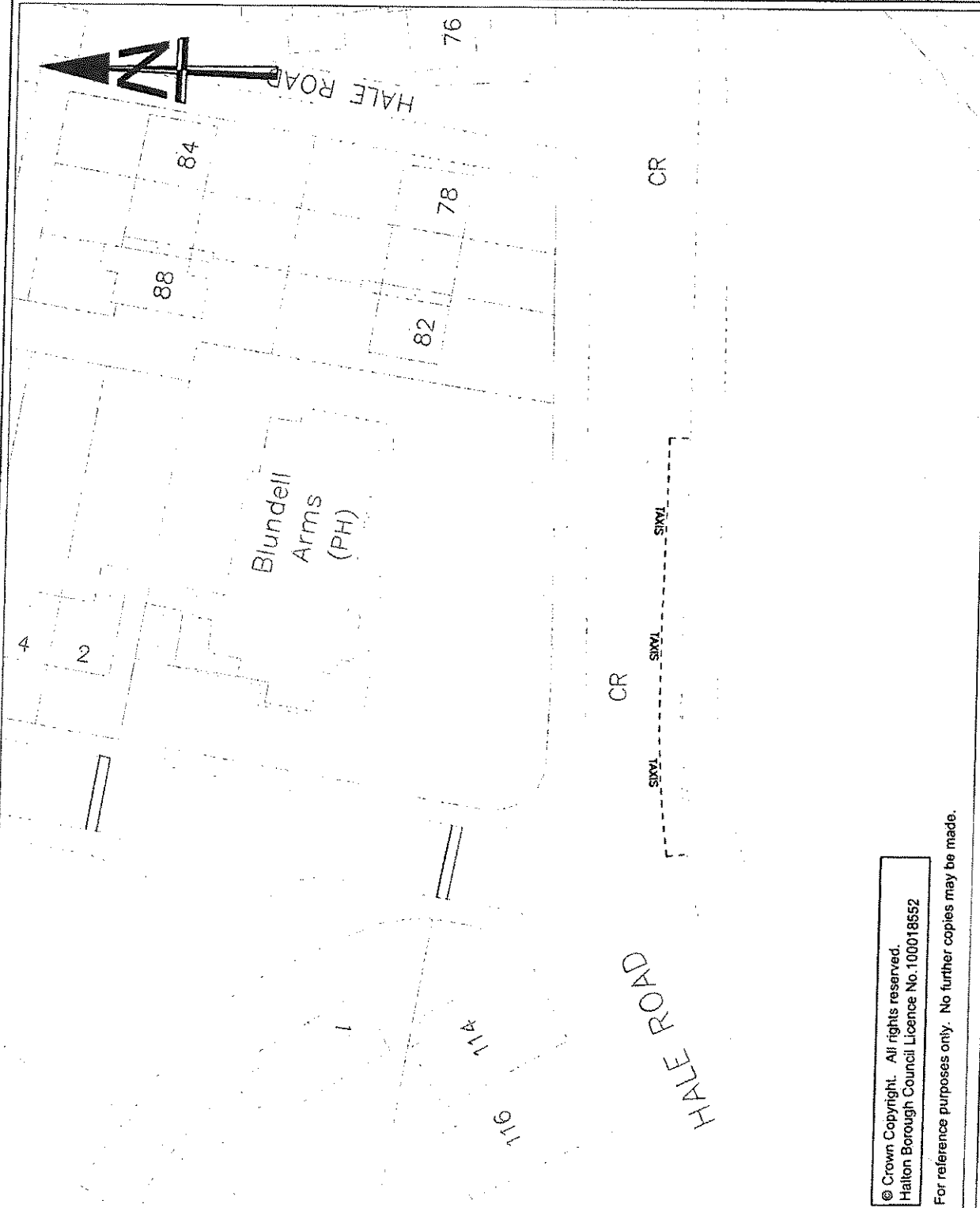

© Crown Copyright. All rights reserved.  
Halton Borough Council Licence No. 100018552

For reference purposes only. No further copies may be made.

Notes

4

MAX. VEHICLES - 3  
ANY TIME

REVISIONS



**POLICY, PLANNING & TRANSPORTATION DEPARTMENT**  
M Noone BA (Hons) MSc, C.Eng, AICE, HCIRT, CMILT  
Operational Director  
Municipal Building, Kingsway  
Widnes, WA9 7GF. Tel: 0303 333 4300

UPTON LANE  
TAXI RANK

Scale: 1:500	Date: 07/19
Drawn by: JB	Checked by:
Plan No:	Rev:

HCS 04

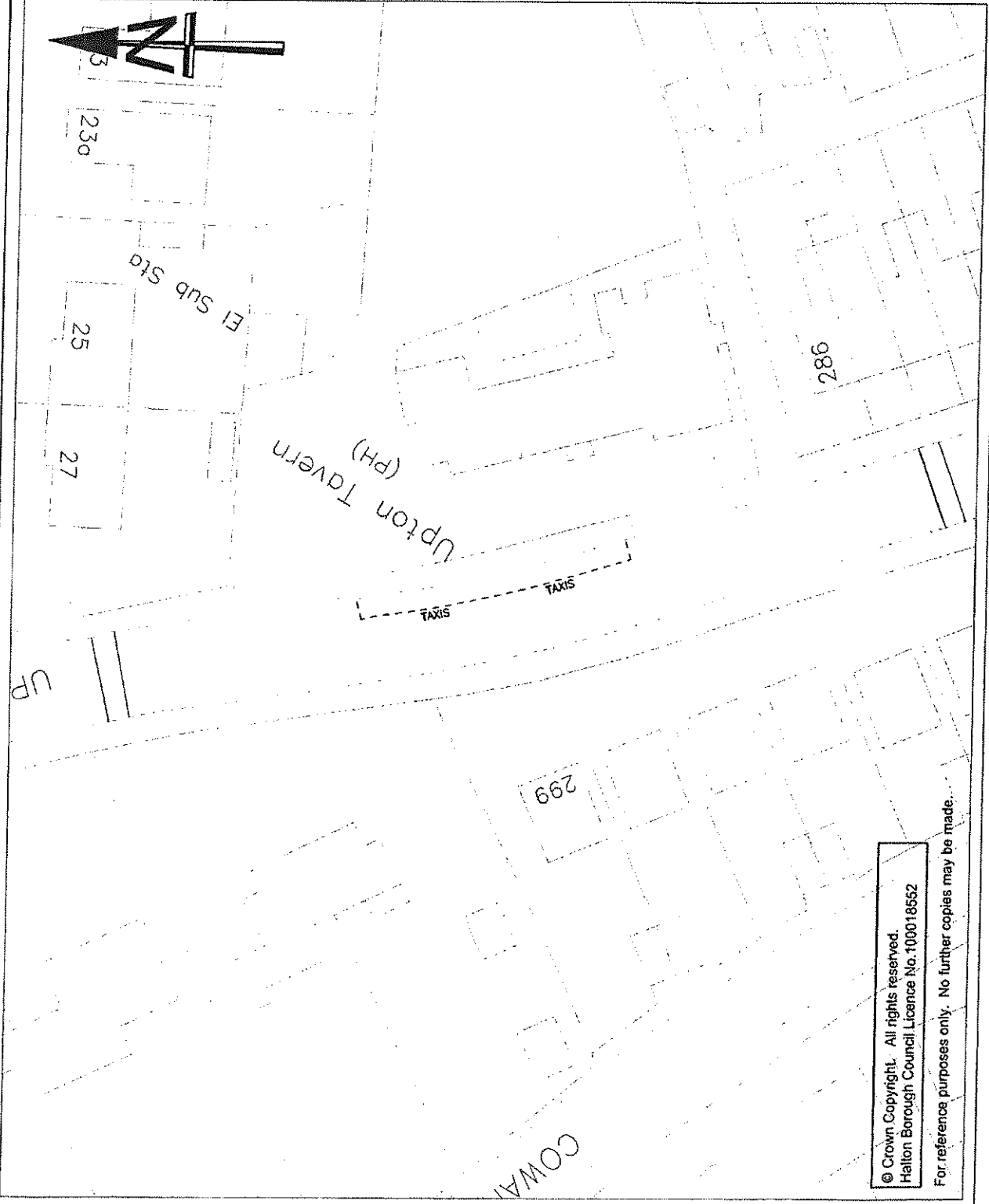

© Crown Copyright. All rights reserved.  
Halton Borough Council Licence No. 100018552

For reference purposes only. No further copies may be made.

NO. 5

MAX. VEHICLES - 5  
ANY TIME

REVISIONS



POLICY, PLANNING

TRANSPORTATION DEPARTMENT

M. Neme BA (Hons) MSc, C. Eng, MICE, MCIT, CMILT  
Operational Director  
Municipal Building, Kingsway  
Widnes, Warr 701P, Tel: 0303 333 4380

DICKSON STREET

TAXI RANK

Scale: 1:500 Date: 07/18

Drawn by: AB Checked by:

Plan No. HCS 05 Rev:

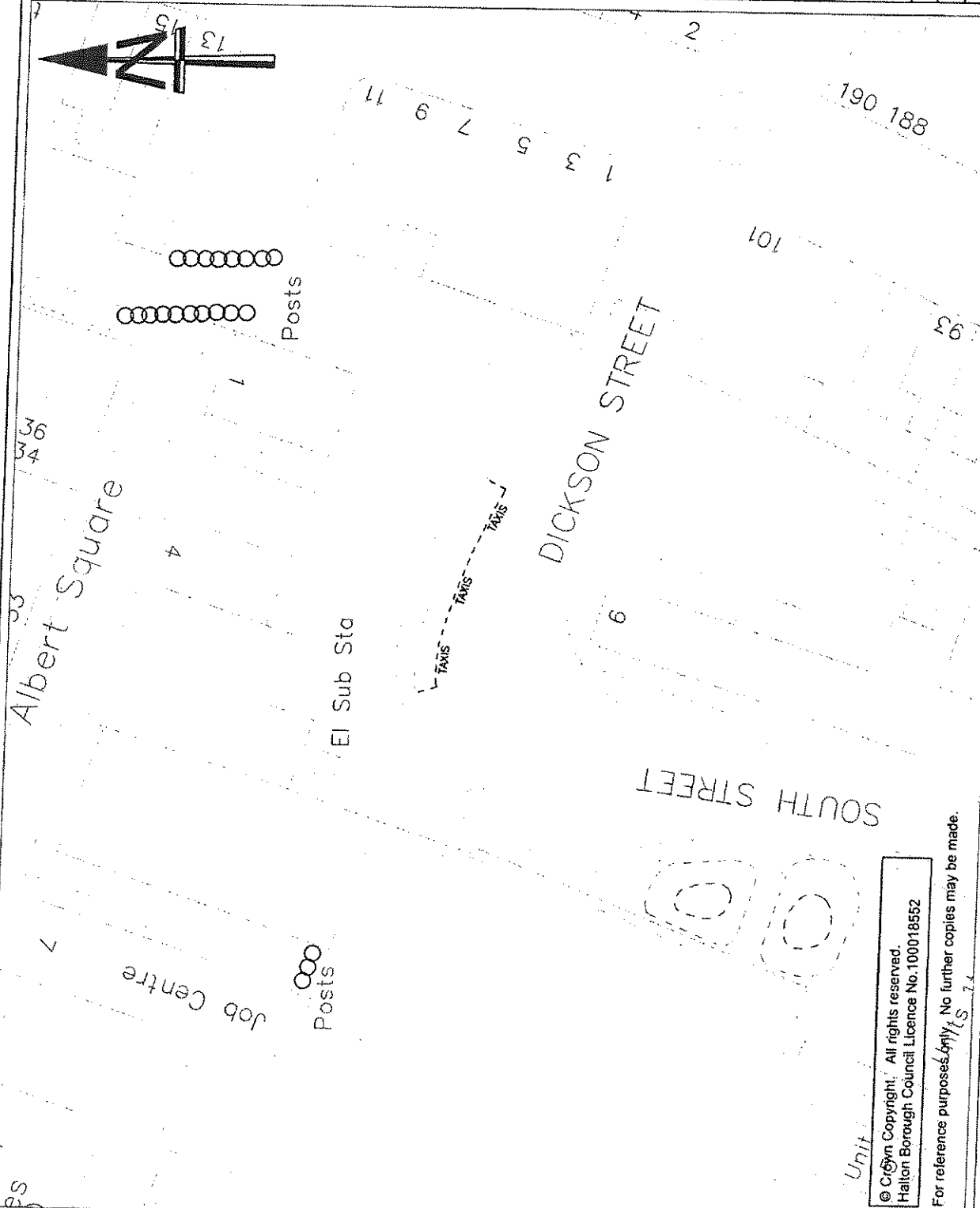

© Crown Copyright. All rights reserved.  
Halton Borough Council Licence No. 100018552

For reference purposes only. No further copies may be made.

Unit

Notes

6

MAX. VEHICLES - 8  
2100 - 0800

REVISIONS



POLICY, PLANNING &

TRANSPORTATION DEPARTMENT

M. Noone BA (Hons), MSc, C. Eng, MICE, MCHRT, CMILT

Operational Director

Municipal Buildings, Kingsway

Widnes, WAB 70F. Tel: 0203 333 4000

VICTORIA SQUARE  
(NEAR ROUNDABOUT)

TAXI RANK

Scale: 1:500	Date: 07/18
Drawn by: JLB	Checked by:
Plan No:	Rev:

HCS 06

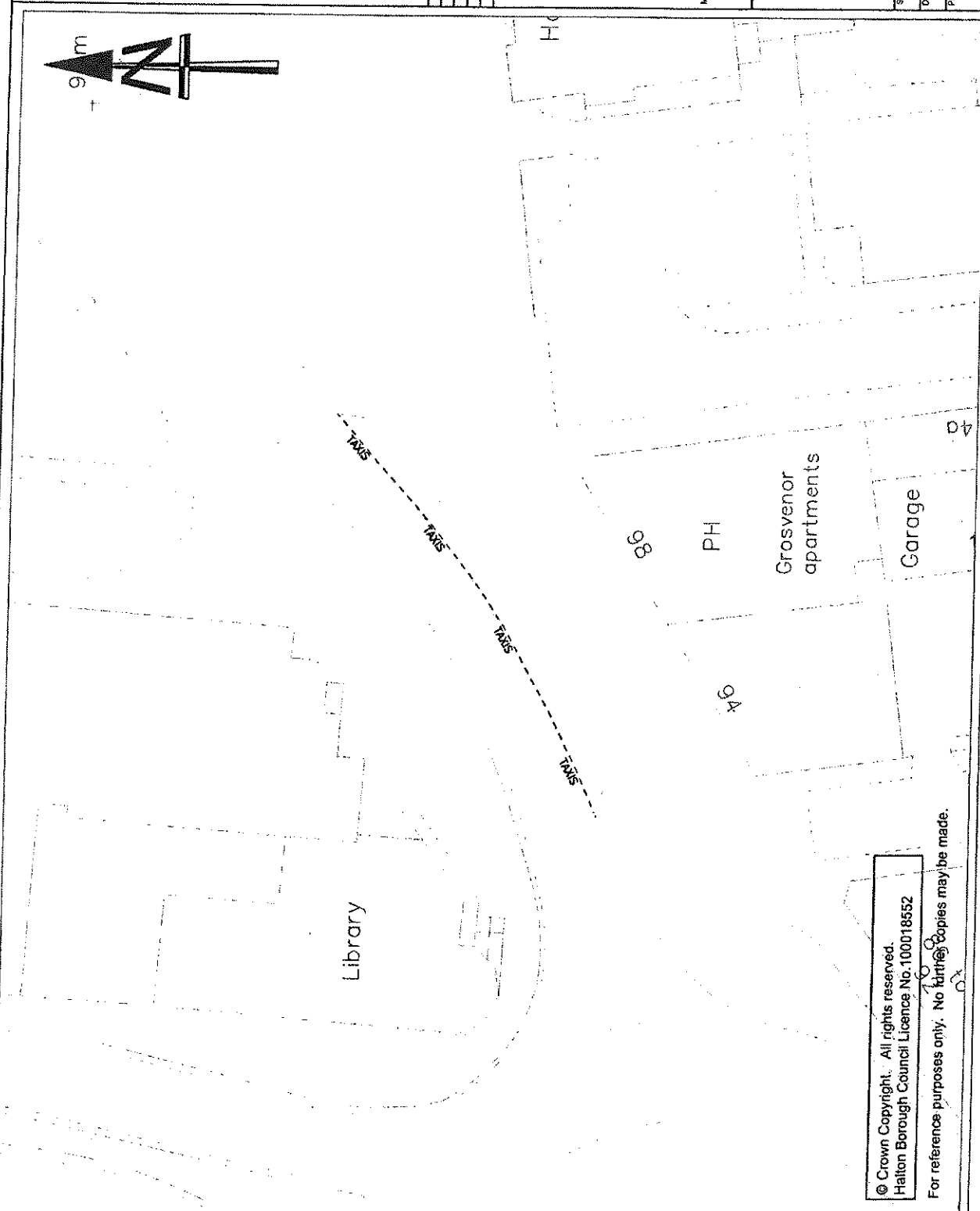

© Crown Copyright. All rights reserved.  
Halton Borough Council Licence No. 100018552

For reference purposes only. No further copies may be made.

Notes:

7

MAX. VEHICLES - 4  
ANY TIME

REVISIONS

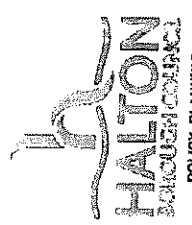

POLICY, PLANNING &  
TRANSPORTATION DEPARTMENT  
M. Noone BA (Hons) MSc, C.Eng, MICE, MCIRT, CMRT, CMI, T  
Operational Director  
Newbold House, Kingstony  
Weymouth, Dorset, DT98 3JG, Tel: 01305 333 4300

PRESCOT ROAD  
(OUTSIDE THE WELLINGTON  
PUB)

TAXI RANK

Scale: 1:500 Date: 07/16  
Drawn by: A.B. Checked by:

Plan No: HCS 07 Rev:



United Services  
Club

Wellington Inn  
(PH)

BROADHEAD

TAXIS TAXIS TAXIS

24.1m

37

35

27

2

© Crown Copyright. All rights reserved.  
Halton Borough Council Licence No. 100018552

For reference purposes only. No further copies may be made.



8

8

MAX. VEHICLES - 10  
0000 - 0800  
0930 - 1430  
1630 - 0000

REVISIONS



POLICY, PLANNING &  
TRANSPORTATION DEPARTMENT  
M Hoone BA (Hons) MSc, C Eng, MICE, MCFE, CMILT  
Operational Director  
Municipal Building, Highway  
Whitby, WMS 70J. Tel: 0303 333 4300

APPLETON VILLAGE  
TAXI RANK

Scale: 1:500	Date: 07/16
Drawn by: JLB	Checked by:

Plan No: HCS 08

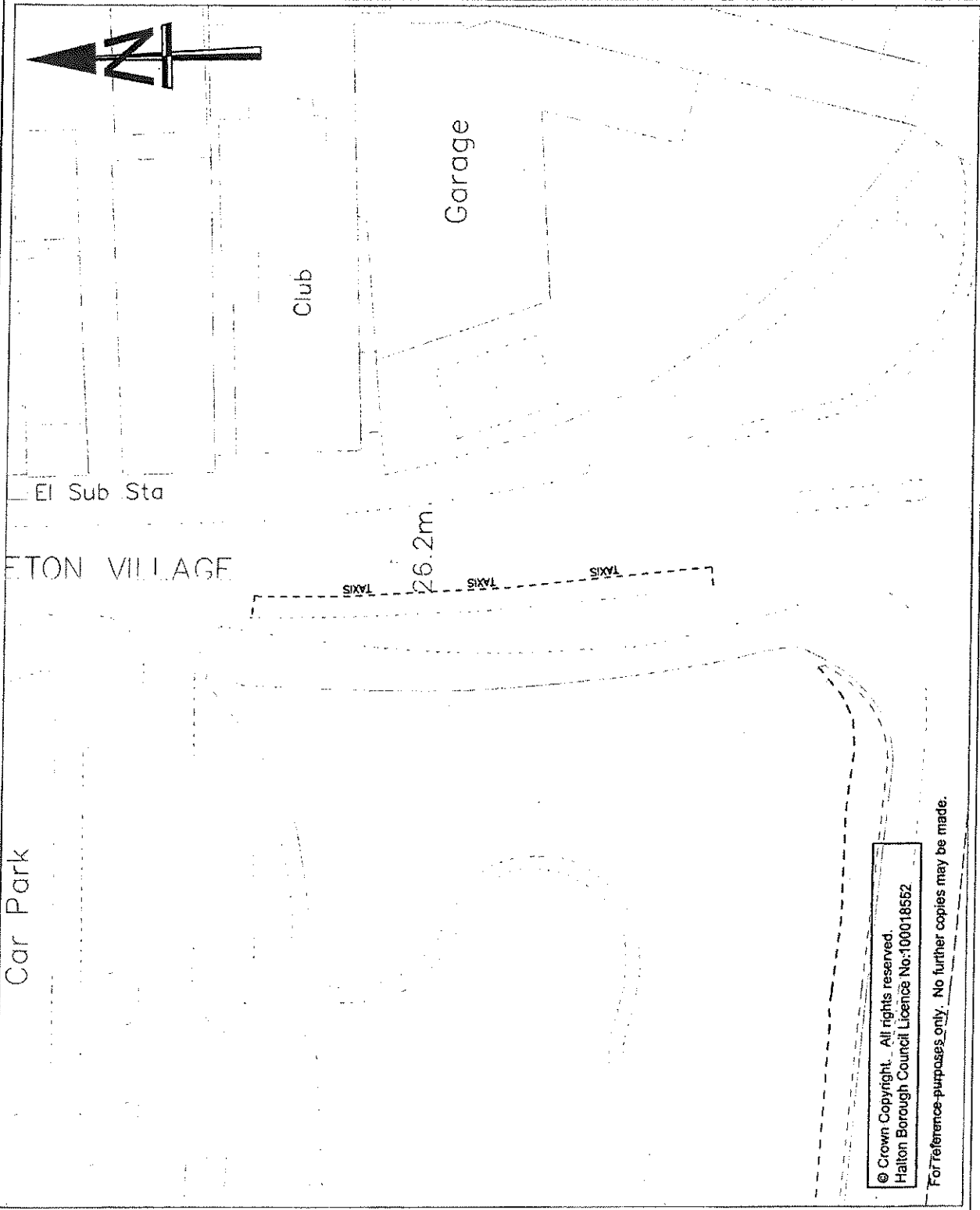

© Crown Copyright. All rights reserved.  
Halton Borough Council Licence No:100018562

For reference purposes only. No further copies may be made.

Notes

9  
MAX. VEHICLES - 4  
ANY TIME



The Hillcrest Hotel

46.4m TAXIS TAXIS TAXIS

46

58

6

ton Lane Mews

© Crown Copyright. All rights reserved.  
Halton Borough Council Licence No. 100018552

For reference purposes only. No further copies may be made.

REVISIONS



POLICY, PLANNING &

TRANSPORTATION DEPARTMENT

M. Nourse BA (Hons) MSc. C. Eng. MICE MCIT CMILT  
Transport Director  
Municipal Engineer  
Widnes, WA9 7DF. Tel: 0203 332 4300

CRONTON LANE  
TAXI RANK

Scale	1:500	Date	07/18
Drawn by	A.B	Checked by	
Plan No.	HCS 09		

New

Notes:

10

MAX. VEHICLES - 8  
2300 - 0600

REVISIONS	

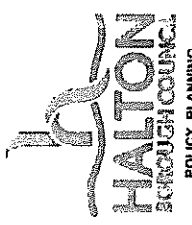

**POLICY, PLANNING & TRANSPORTATION DEPARTMENT**  
 M House BA (Horn) Misc Clerg WICE MCRT CMRT  
 Planning Officer  
 Municipal Buildings, Fosse  
 WIDNES, WARR 70F. Tel: 0203 233 4300

**WIDNES ROAD  
(SORTING OFFICE)**  
TAXI RANK

Scale	1:500	Date	07/06
Drawn by	JLB	Checked by	
Plan No.	HCS 10		
Rev			

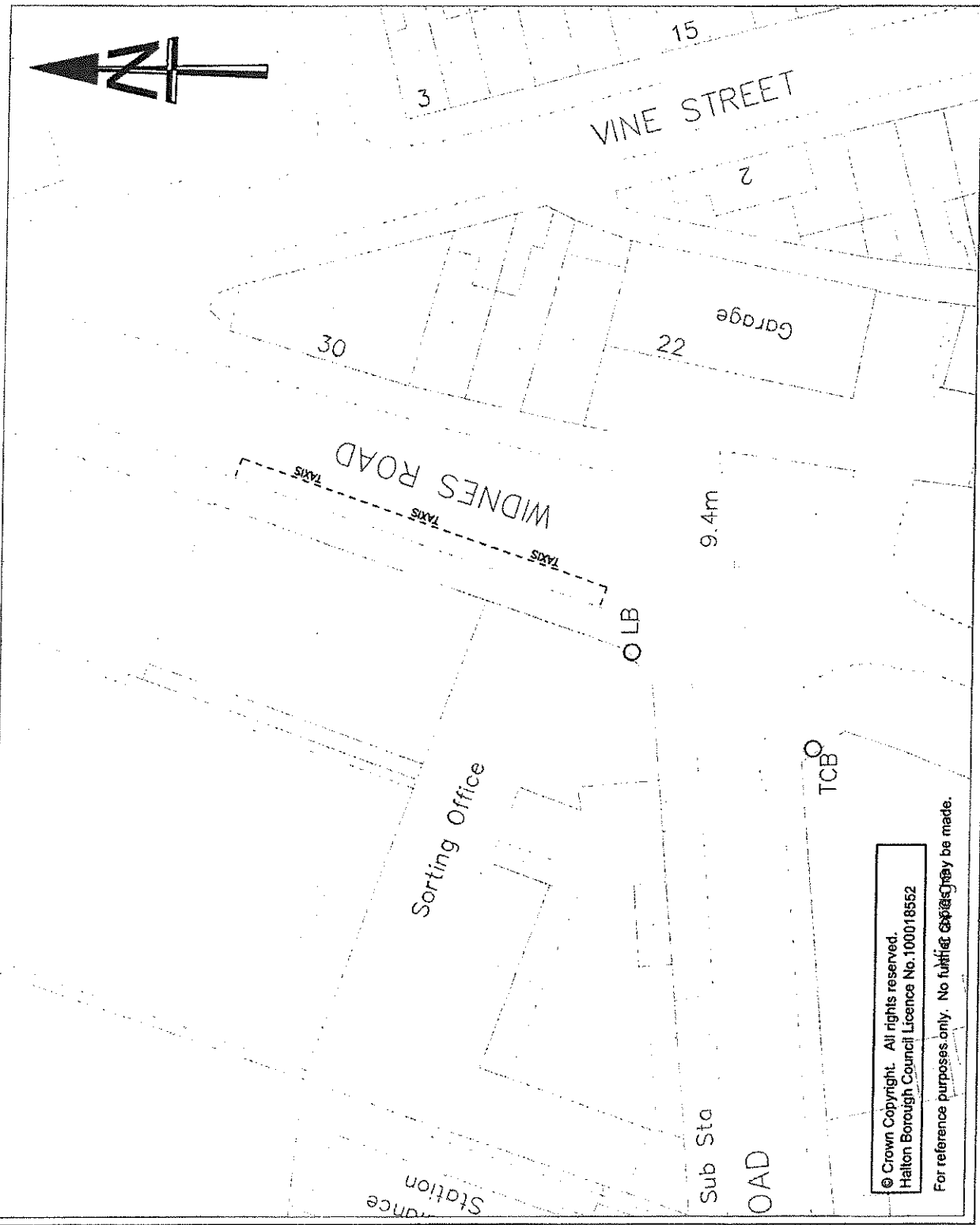

© Crown Copyright. All rights reserved.  
 Halton Borough Council Licence No. 100018562

For reference purposes only. No further copies may be made.

Notes:

11

MAX. VEHICLES - 3  
1800 - 0600

REVISIONS



POLICY, PLANNING &

TRANSPORTATION DEPARTMENT

M. Moore BA (Hons) MSc C.Eng MICE MCHRT CMILT  
Operational Director  
Municipal Buildings, Kingsway  
Worke, WAB TQ9 7DF. Tel: 0303 333 4300

ALBERT ROAD  
(OUTSIDE WETHERSPOONS)

TAXI RANK

Scale: 1:500 Date: 07/11/11

Drawn By: AJB Checked By:

Plan No: HCS 11 Rev:



105

101

17.1m

4

PH

TAXI TAXI TAXI TAXI TAXI

ALBERT ROAD

87

97

07

2

87

3

El Sub Sta

1

2

11

© Crown Copyright. All rights reserved.  
Halton Borough Council Licence No. A00018552

For reference purposes only. No further copies may be made.

NO. 12  
 MAX. VEHICLES - 3  
 1800 - 0600

REVISIONS	

**HALTON BOROUGH COUNCIL**  
 POLICY, PLANNING &  
 TRANSPORTATION DEPARTMENT  
 M. Moore BA (Hons) MSc, CLERG, MICE, MCHT, CMILT  
 Operational Director  
 Municipal Building, Kington  
 Wetherby, WYO 701 - Tel: 01937 333 4300

ALBERT ROAD  
 (OPP NO. 70)  
 TAXI RANK

Scale	1:500	Date	07/06
Drawn By	JLB	Checked By	
Plan No.	HCS 12		

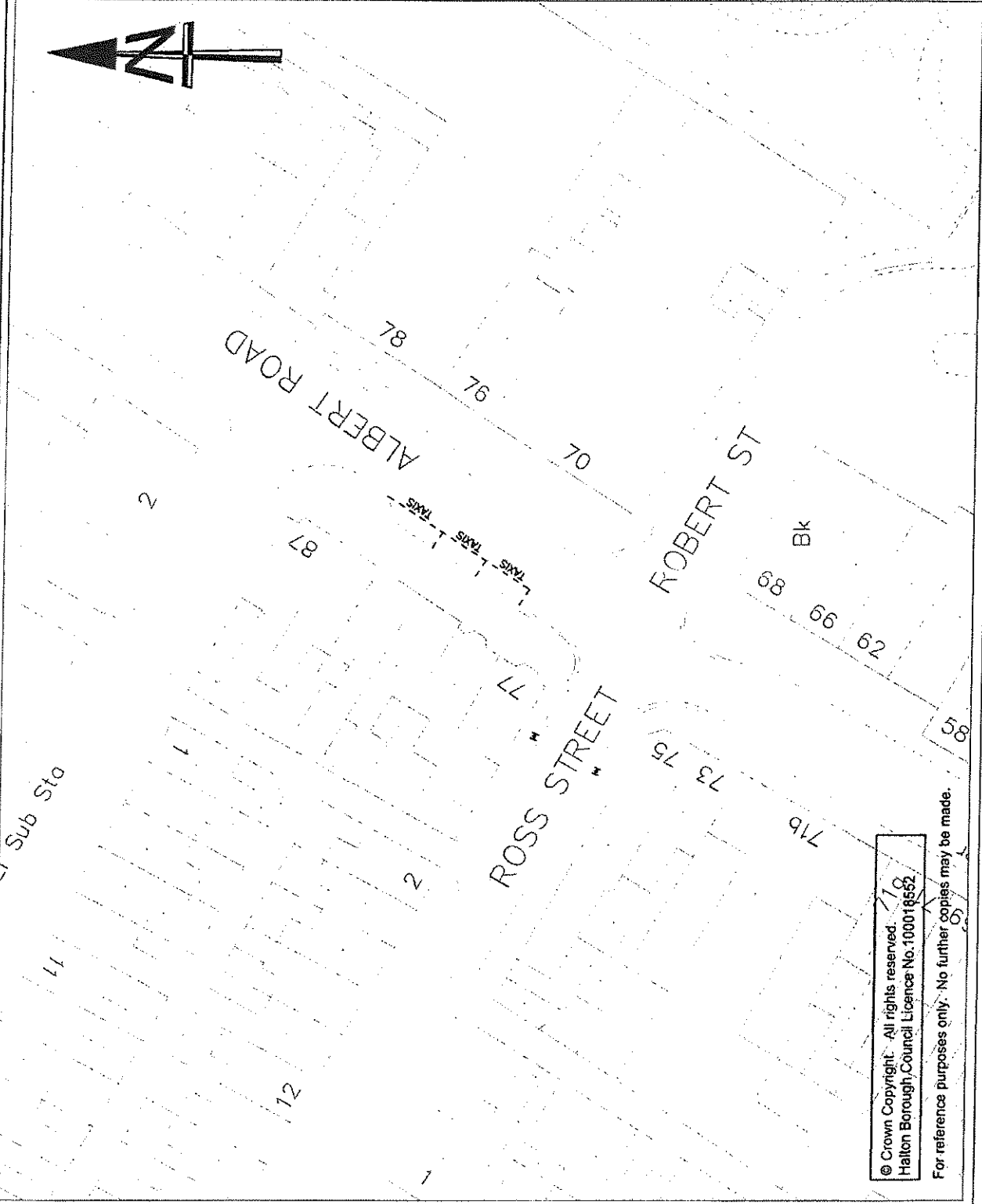

© Crown Copyright. All rights reserved.  
 Halton Borough Council Licence No. 100018552  
 For reference purposes only. No further copies may be made.

Notes:

13

MAX. VEHICLES - 3  
1800 - 0600

REVISIONS



POLICY, PLANNING &

TRANSPORTATION DEPARTMENT

M. Neave BA (Hons) MSc, C. Eng, MRCE, MCHRT, CHART  
Operational Director  
Motorway Planning, Kingsway  
Widnes, Warr. 75P. Tel: 0200 333 4300

ALBERT ROAD  
(OUTSIDE 71b)

TAXI RANK

Scale: 1:500 Date: 07/18  
Drawn by: JLB Checked by:

Plan No: HCS 13 Rev:

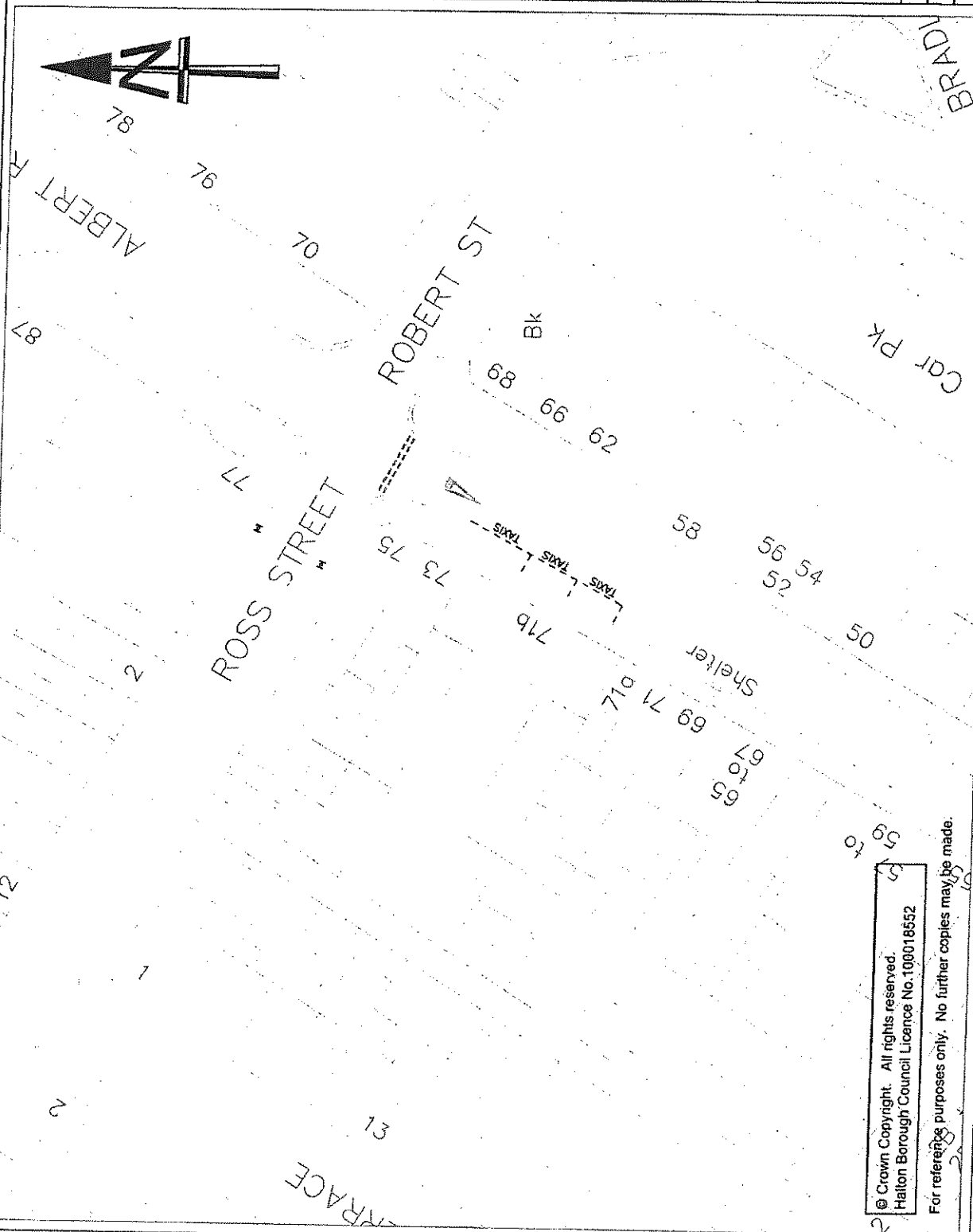

© Crown Copyright. All rights reserved.  
Halton Borough Council Licence No. 100018552

For reference purposes only. No further copies may be made.

Notes:

14

MAX. VEHICLES - 8  
ANY TIME

REVISIONS



**HALTON BOROUGH COUNCIL**  
POLICY, PLANNING &  
TRANSPORTATION DEPARTMENT  
M Howe BA (Hons) MSc CEM MICE MCBT CMILT  
Operational Director  
Municipal Building, Kingsway  
Widnes, Warr. WA8 7DR. Tel: 0300 333 4300

PUBLIC HALL STREET  
TAXI RANK

Scale: 1:200	Date: 01/16
Drawn by: JAB	Checked by:
Plan No: HCS 14	

Rev:



Garage

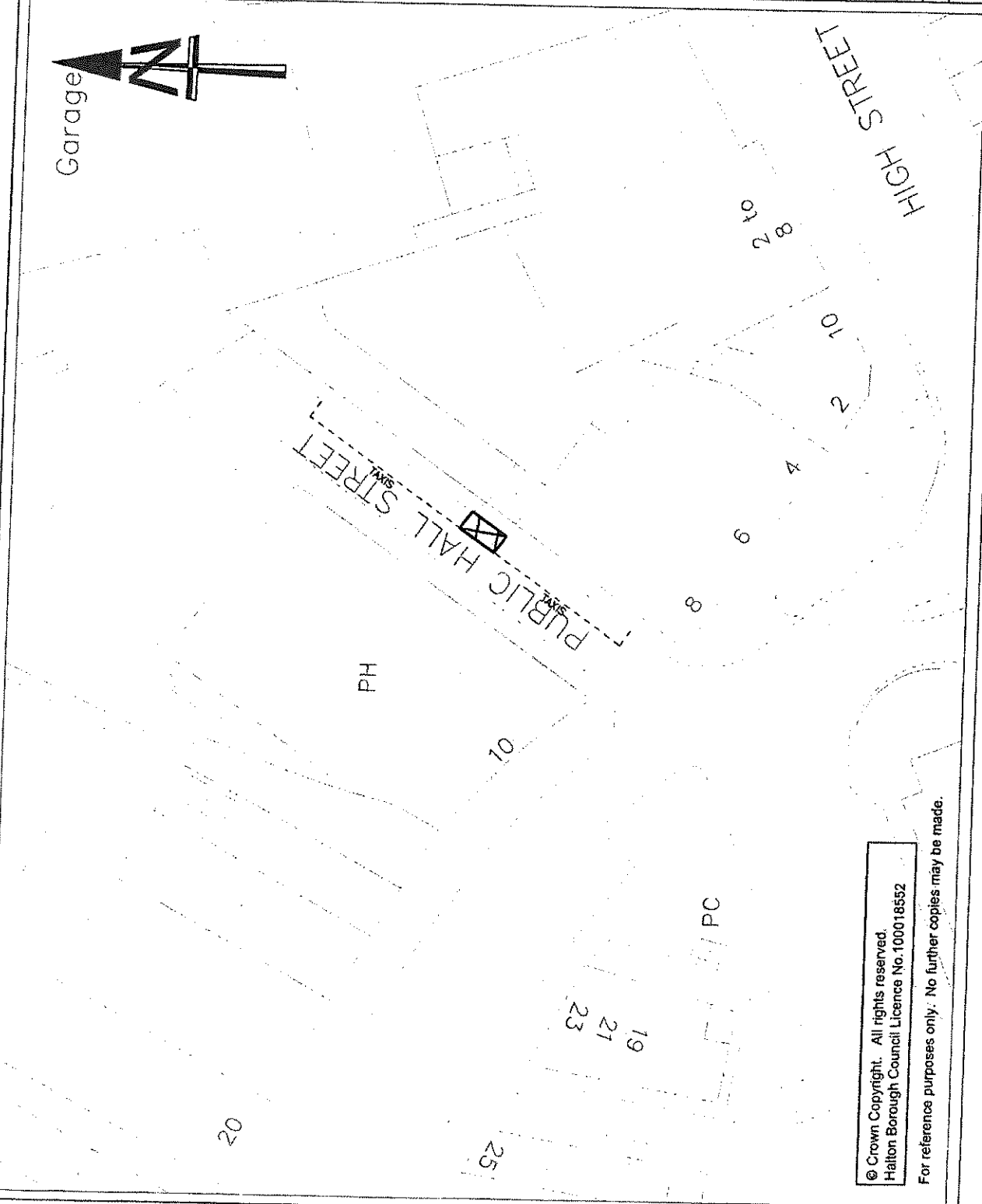

© Crown Copyright. All rights reserved.  
Halton Borough Council Licence No.100018552

For reference purposes only. No further copies may be made.

Notes:

15

MAX. VEHICLES - 3  
ANY TIME

REVISIONS



POLICY, PLANNING &

TRANSPORTATION DEPARTMENT

M. Nunn BA (Hons) MSc, C. Eng, MICE, MCHRT, CMILT

Operational Director

Municipal Buildings, Kingsway

Worke, Wals TQF, Tel: 0203 333 3300

SECOND AVENUE  
(SHOPPING CITY)

TAXI RANK

Scale: 1:500	Date: 07/04
Drawn by: JLB	Checked by:
Plan No:	Rev:

HCS 15

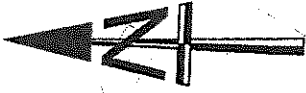

(below)

COND AVENUE  
6.8m

AVENUE  
Busway (Elevated Road)

Rutland House  
Bus Station (below)

TAXIS

SECOND AVENUE

THIRD AVE

Bank Bank Bank  
FB

9 Bank  
10

Orchard

© Crown Copyright. All rights reserved.  
Halton Borough Council Licence No. 100018552

For reference purposes only. No further copies may be made.

Bus



16  
 MAX. VEHICLES - 5  
 2200 - 0600

REVISIONS	

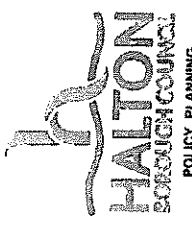

POLICY, PLANNING &  
 TRANSPORTATION DEPARTMENT  
 14 Noone BA (Hemel) MISC C/ENG NICE MCKIT CMILT  
 Municipal Buildings, Kettering  
 Wonders, WASH TGF, Tel: 0330 333 4390

HIGH STREET  
 TAXI RANK

Scale	1:500	Date	07/18
Drawn by	AB	Checked by	
Plan No.	HCS 016		

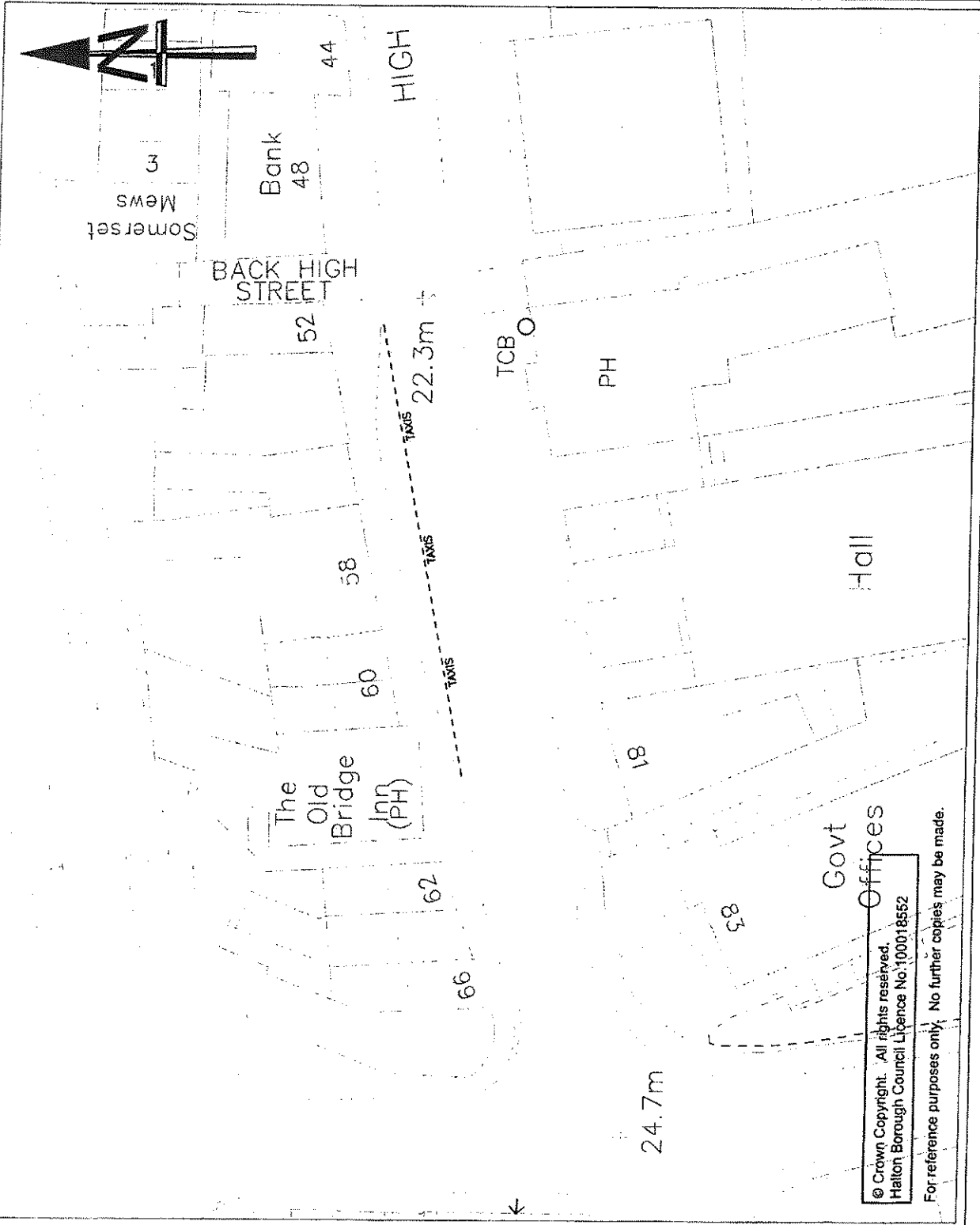

© Crown Copyright. All rights reserved.  
 Halton Borough Council Licence No: 100018552

For reference purposes only. No further copies may be made.

17

MAX. VEHICLES - 5  
2200 - 0600



TRANSPORTATION DEPARTMENT  
POLICY, PLANNING &  
M. Nones BA (Hons) MSc C. Eng. MICE MCHRT CHART  
Consultant Director  
Municipal Engineer  
Widnes, WA8 7QF. Tel: 0300 333 4300

HIGH STREET  
TAXI RANK

Scale:	1:600	Date:	07/18
Drawn by:	J.B.	Checked by:	
Plan No.	HCS 17		

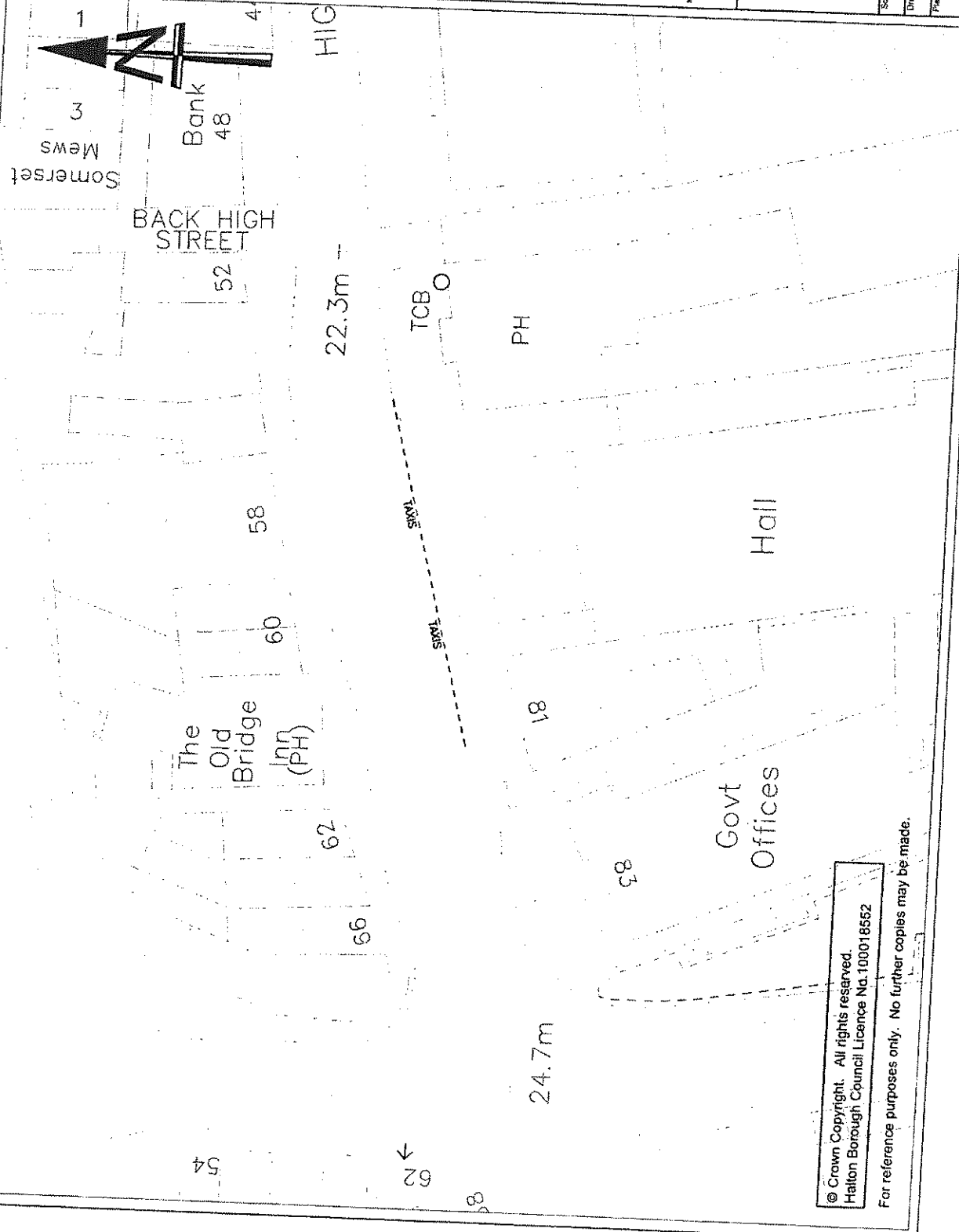

© Crown Copyright. All rights reserved.  
Halton Borough Council Licence No. 100018552

For reference purposes only. No further copies may be made.

18

MAX. VEHICLES - 4  
2200 - 0600



POLICY, PLANNING &  
TRANSPORTATION DEPARTMENT  
M. Howe BA (Hons) MSc C.Eng. MICE, MRICHT CMILT  
Operational Director  
Municipal Building, Kingsway  
Widnes, WA9 7DP. Tel: 033 333 4390

BRIDGE STREET  
(OUTSIDE OF WILSONS)  
TAXI RANK

Scale: 1:500	Date: 07/16
Drawn by: JEB	Checked by:
Plan No: HCS 18	
Rev:	

© Crown Copyright. All rights reserved.  
Halton Borough Council Licence No. 100018552

For reference purposes only. No further copies may be made.

Notes:

19

MAX. VEHICLES - 8  
2000 - 0600

RESPONSIBILITY



POLICY, PLANNING &  
TRANSPORTATION DEPARTMENT  
41 Moore BA (Phone) 4435; C. EPPANCE MCHPT CHIEF  
Operational Director  
Newspaper Building, Kingway  
Widnes, Warr. Ch. Tel: 0303 333 4300

HIGH STREET  
(ADJ TO MERSEY ROAD)  
TAXI RANK

Scale	1:500	Date	01/16
Drawn by	AB	Checked by	
Plan No:	HCS 19		



10.0m

143 147 151  
145 149 153

PENKETH'S LANE

9 11 21

HIGH STREET

LOADING ZONE

TAXIS

TAXIS

TAXIS

TAXIS

TAXIS

TAXIS

TAXIS

TAXIS

TAXIS

TAXIS

TAXIS

PH

Penketh

El Sub Sta

NELSON ST

2 PO

14.0m

PUBLIC HALL STREET

PH

© Crown Copyright. All rights reserved.  
Halton Borough Council Licence No. 100018552

For reference purposes only. No further copies may be made.

SCALE

20

MAX. VEHICLES - 6  
2000 - 0600



TCB

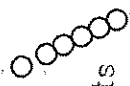

Posts

19.2m

SWAY TAXIS

Bank

Health Centre

63

42

© Crown Copyright All rights reserved  
Haltom Borough Council Licence No. 100019552

For reference purposes only. No further copies may be made.



POLICY, PLANNING &  
TRANSPORTATION DEPARTMENT  
M. NIXON BA (Hons) MSc, C. Eng. MICE MCIT CMILT  
Operations Director  
Municipal Buildings, Market Street,  
Widnes, WA8 7DF. Tel: 0203 333 0300

HIGH STREET  
(EAST OF CO-OP CAR PARK  
ENTRANCE)  
TAXI RANK

Scale:	1:500	Date:	07/18
Drawn by:	48	Checked by:	
Plan No:			

HCS 20

Rev:

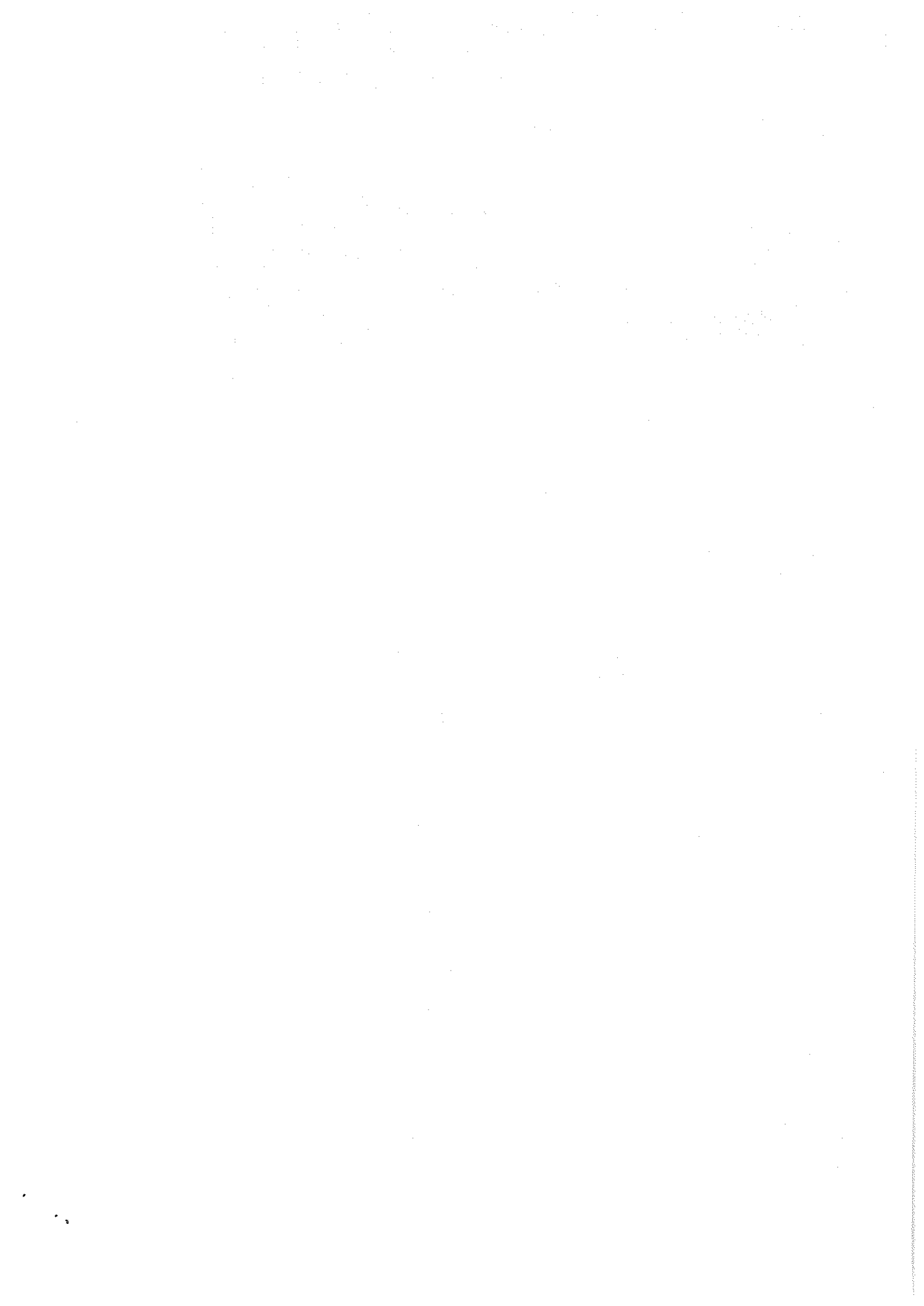

## HALTON BOROUGH COUNCIL

### THE HALTON BOROUGH COUNCIL (VARIOUS HACKNEY CARRIAGE STANDS, WIDNES AND RUNCORN) ORDER, 2018

The Halton Borough Council in exercise of the powers under the Local Government (Miscellaneous Provisions) Act 1976 Sections 63 ("the 1976 Act") and all other enabling powers, after consultation with the Chief Officer of Police hereby makes the following Order:-

1. The Order was made on 18 October 2018 shall come into operation on 1 November 2018 and may be cited as the Halton Borough Council (Various Hackney Carriage Stands, Widnes and Runcorn) Order 2018.
2. In this Order:-
  - "the Council" means the Council of the Borough of Halton
  - "hackney carriage" has the same meaning as in the 1847 Act
  - "the 1847 Act" means the provisions of the Town Police Clauses Act 1847 with respect to hackney carriages
  - "the 1984 Act" means the Road Traffic Regulation Act 1984 or any enactment which the 1984 Act superseded
  - "the Order Plan" means the plans attached to this Order the numbers of which are listed in the Schedule to this Order.
3. The stands described in the Schedule to this Order on the Order Plan are hereby appointed stands for hackney carriages for the whole or any part of a day as therein described and for the numbers of vehicles therein described.
4. No person shall cause or permit any vehicle other than a hackney carriage to wait on any stand for hackney carriages during any period for which that stand has been appointed, or is deemed to have been appointed by the Council under the provisions of section 63 of the 1976 Act.
5. All previous orders made by the Council under section 63 of the 1976 Act are hereby revoked.
6. Any provisions contained in any existing Order made by the Council under the 1984 Act which is inconsistent with any of the provisions contained in this Order are hereby revoked solely to that extent.

**THE COMMON SEAL of THE COUNCIL  
of THE BOROUGH of HALTON was  
hereunto affixed in the presence of:**

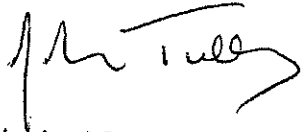
A handwritten signature in black ink, appearing to be 'M. Kelly', written over a horizontal line.

Authorised Signatory

